

WIDEBAND SHF DIRECTION FINDER

SVUCIDF3796F

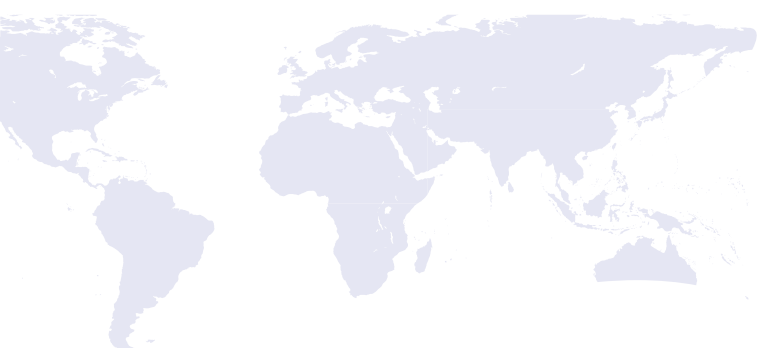

SVUCIDF3796F is taken account as one of the most top-leading advanced V/U/SHF band DFs in the world, which benefits from modern processing algorithms such as sparse and vector correlation. The system works continuously in the frequency range 20MHz to 8.2GHz by using two arrays of 9-element antennas. It also benefits from advanced subsystems to support surveying quality.

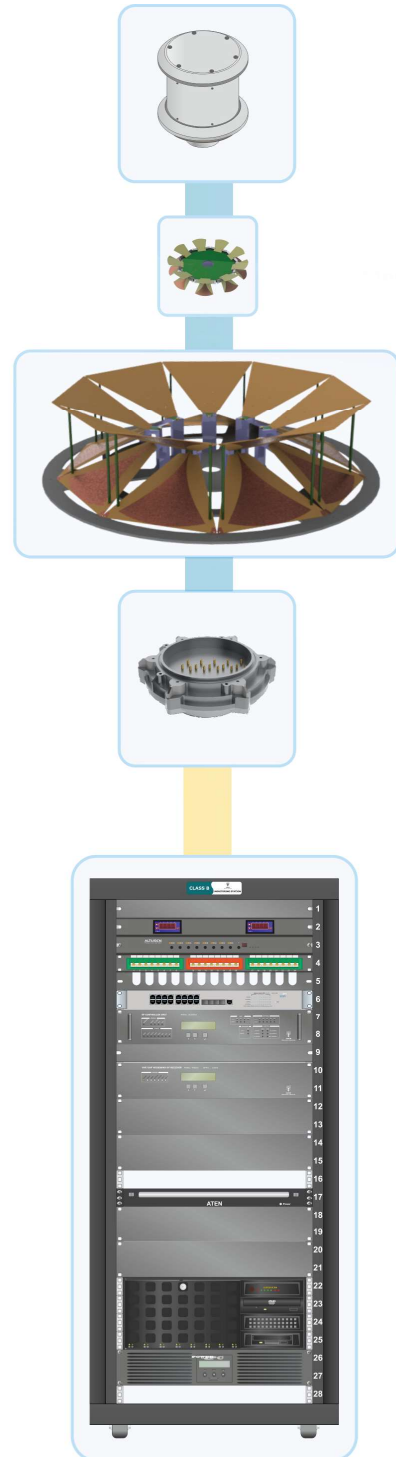

Technical Specification

Frequency range	30MHz to 8500MHz
DF method	Correlative interferometer(Super Resolution Methods)
Instrument DF accuracy	0.2° RMS
System DF accuracy (@ test field)	2° RMS
Display	azimuth vs. frequency, level vs. frequency, polar diagram, histogram, waterfall, real-time IF panoramic display (bandwidth 100 kHz or 1 MHz)
Display resolution	0.1° to 5° (selectable)
DF sensitivity	-10 dB μ V/m to 2 dB μ V/m (typ.)
Operating modes	FFM (Fixed Frequency Mode), WBM (Wide Band Mode), SCAN (f-SCAN, m-SCAN)
Instantaneous bandwidth	10 MHz(Optional: 20MHz/80MHz)
Frequency span in wideband mode	1 MHz/2 MHz/10MHz
Minimum signal duration	0.5 ms
Scan speed with 20 kHz resolution	up to 500 MHz/s
Adjacent channel suppression \leq10 kHz	70 dB (FFM), 60 dB (SCAN)
Modes of demodulation Dynamic range (incl. AGC)	CW, AM, FM, SSB

+41 79 708 10 94

georg.stirnemann@symlab.ch
www.symlab.ch

Bollhoelzliweg 36, 3067 Boll, Switzerland

